

YACHT CONTROLLER  
The Pioneer of  
Wireless Remote Controls for Mooring  
PRESENTS

MAXIMO



25  
YEARS OF SUCCESS



UP TO 26 METRES

World Leader in Maneuvering Technology



YACHT  
CONTROLLER®  
YACHTING INNOVATIONS

[www.yachtcontroller.it](http://www.yachtcontroller.it)



# Since 1998, we have imagined a new way to moor a yacht

In 2002, we transformed that vision into reality launching the **world's first wireless docking system** and creating an entirely new segment of the Marine Market.

Proudly **Made in Italy** with care, every Yacht Controller system is **engineered in Switzerland** with meticulous attention to detail, crafted to suit the unique characteristics of each individual vessel.

## World Leader in Manoeuvring Technology

Our deep expertise and passion have earned us long-standing partnerships with the world's leading control head Manufacturers with whom we've developed fully compatible, dedicated interfaces for seamless integration.

Yacht Controller is not just equipment: it's innovation, heritage and excellence brought together to elevate your entire onboard experience.

## Take Command of Your Journey

With Yacht Controller, every movement becomes easier, every manoeuvre smoother and every moment on board, more enjoyable. Yacht Controller takes the stress out of berthing and anchoring your vessel.

**Dock with precision. Navigate with confidence. Enjoy the freedom**



[www.yachtcontroller.it](http://www.yachtcontroller.it)

# Designed to Feel Perfect in Your Hands

Choose the **transmitter** that matches your style and comfort:



## MTJ

Luxury 3-axis joystick with a custom ergonomic grip



## MTL

Levers that give the same feeling as the helm controls



## MTK

Tactile button pad—easy to use without looking down at the transmitter

## Every Transmitter Offers:

- ▶ Dual isolated frequency bands - **49 channels**
- ▶ A unique encrypted ID for maximum security
- ▶ Auto shut-off if communication is lost
- ▶ Vibration alerts to catch your attention instantly
- ▶ All have Ultra-durable silicone buttons/levers/ joysticks (250,000+ cycles)
- ▶ Dual LED indicators for instant connection feedback while in use

LED indicators display real-time battery charge status: green, white, violet then red when it's time to recharge.

## Two Modes. Unlimited Control

Switch easily between Manual Mode and Automatic Mode, tailoring your manoeuvring style to every situation. In Manual Mode, each single command individually activates only one function. Automatic Mode groups and combines multiple functions with the use of a single finger. Choose joystick emulation or the enhanced Automatic 2 mode, perfect for those who want next-level assistance.

Whether you use a bow thruster, both thrusters or **virtual thrusters**, you always get the ideal manoeuvring options.



[www.yachtcontroller.it](http://www.yachtcontroller.it)



# Fine-Tuned Performance. Endless Personalization

## Control Head Setup

Customize electronic control head type both analog or CAN-bus with calibration and precision.

## Thrusters Configuration

Choose models, enable bow and/or stern thrusters and invert command directions as needed.

## Acceleration Profiles

Pick from preset engine profiles up to five, for each type of vessel (Yacht, Trawler, Catamaran etc.) or create your own:

- *Define acceleration percentage*
- *Customize ramp-up times*
- *Match performance to sea state, boat type and personal preference*
- ***Define the acceleration proportionality with our TJ joystick***

Acceleration percentage refers to the relative RPM compared to the engine's maximum and is reached, depending on the profile, within the specified ramp-up time. To activate acceleration, press the "S" button. To move to the next level, press the "S" button again to select the acceleration that best suit the sea and wind conditions. The current acceleration level is indicated by the multicoloured LED next to the "S" button.

Your boat, your rules

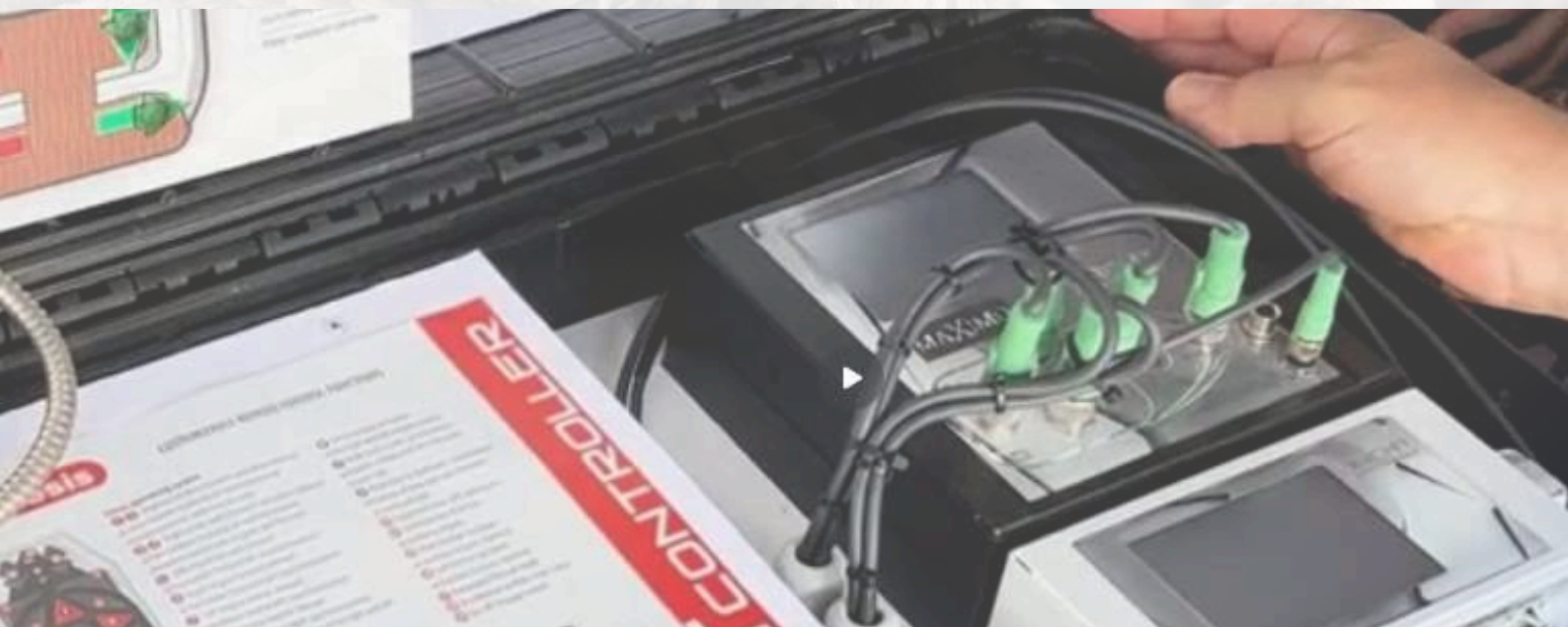

[www.yachtcontroller.it](http://www.yachtcontroller.it)

# Virtual Thrusters & Custom Rotations Smart Technology To Move Your Way

Even without thrusters, Yacht Controller's advanced software simulates lateral movement with counter-rotating engines. This **Virtual Thruster technology** allows the system to emulate bow and stern thruster behaviour using only the engines, with fully customizable parameters to adapt to your vessel.

Perfect for:

- Side-to-side motion
- Tight space navigation
- Vessels with bow thrusters only or none at all

Plus, create fully custom rotation behaviours defining clockwise or counterclockwise movements with precise RPM and timing for ultimate control in any scenario.

## Side Docking – Precision Lateral Manoeuvring

Experience absolute control when approaching any dock. Side Docking Mode assists you in achieving smooth, accurate lateral movement approaching tight spaces, crowded marinas and side-on berths, remarkably simple. The system aligns your vessel with confidence, ensuring graceful, predictable motion every time you approach the dock.

## Dock Like Never Before – The HOLD Function

Meet the feature that revolutionizes single-handed docking. The Hold function presses your boat gently and securely against the dock using proportional bow and stern thrusters, giving you time to manage lines effortlessly.

### Why You'll Love It:

- Keeps your boat perfectly aligned alongside the dock
- Lets one person handle mooring with total control
- Fine-tune power in 5% increments for unmatched precision
- Quick activation and instant deactivation



UP TO 26 METRES

[www.yachtcontroller.it](http://www.yachtcontroller.it)



# Dynamic Positioning Hold Your Position Effortlessly



With Dynamic Positioning, your yacht maintains its position and heading automatically.

This cutting-edge system uses engines and thrusters to make real-time adjustments, allowing you to hold station effortlessly.

Whether you're waiting at a bridge, preparing to dock, waiting for re-fuel or pausing mid-sea, Dynamic Positioning gives you the freedom to stay still without constant corrections or anchor stress.

## Smart Wi-Fi Integration Total Visibility Anytime, Anywhere

The MAXIMO receiver includes an optional LCD display accessible onboard or remotely via Wi-Fi for maximum flexibility, it can also be seamlessly controlled from your smartphone, PC or tablet:

- Monitor all operations live
- Adjust settings with ease
- Connect the secondary Wi-Fi network (2.4 or 5 GHz) for updates or remote support

**Plus, mirror all system data or operate directly on next-generation chartplotters** for a seamless navigation experience.

With auxiliary Wi-Fi, automatically download and install the latest firmware for transmitter, receiver and interface. This feature ensures your system remains up to date and fully optimized with minimal effort. Secure access with advanced user passwords.

## Exclusive Secure Factory Access no technician required onboard:

*Through a secure VPN connection, the factory can access the system directly to add new options, perform updates or quickly adjust the unit's settings, all without removing the unit or requiring a technician on board, ensuring even faster and more efficient support.*



UP TO 26 METRES

[www.yachtcontroller.it](http://www.yachtcontroller.it)

# Professional-Grade Safety, Diagnostics & Interference Control

## Radio Test & Spectrum Analyzer

- View detailed diagnostics on transmission and reception of Yacht Controller data to monitor performance
- Secure access with advanced, installer and super-installer passwords, easily modified via touch interface
- Monitor transmitter and receiver signal strength and minimum RSSI thresholds
- Automatically adjusts for each frequency band the transmission channel to resolve communication issues
- Graphical display of interference on both frequency bands, with real-time indicators: green (normal signals), blue (other Yacht Controller devices), red (unidentified interference)



## Expand Your System. Unlock More Possibilities

Control additional onboard functions from the transmitter:

- Horn
- Swim platform, Stern hatch
- Cablemasters
- Winches
- Any ON/OFF device

And stay future-ready with:

- Optional feature activation anytime
- Remote diagnostics worldwide
- Seamless online firmware updates



New features coming soon  
Your system grows with your yacht



UP TO 26 METRES

[www.yachtcontroller.it](http://www.yachtcontroller.it)





## Premium Certifications & OEM Partnerships

Every product is:

- CE&FCC certified
- Integrated with OEM-approved interfaces
- Built under the philosophy: Safety Comes First



## Technical Specifications

- Power Supply: 12 ÷ 24 VDC  $\pm$  5 % max
- CPU: Powered by blazing-fast 64-bit Quad-Core Processor 1.4 GHz
- Display: 3.5" resistive LCD touch screen, 480x320
- **Frequencies: 433 MHz and 868 or 916 MHz**
- **Number of frequency Channels 49: 7 x 7**
- Wi-Fi: 2.4/5 GHz
- Relay Outputs: max 8 x digital DO relays 48V 1A (bow/stern thrusters, anchor 1 & 2, or other ON/OFF devices like gangways, lights, etc.)
- Expansion Slots: 2 combinable with 12-bit analog I/O or CAN bus
- Operating Temperature: -10°C to +60°C
- Optional: Ethernet for chartplotter connection, dual-band Wi-Fi 2.4/5 GHz



**25**  
YEARS OF SUCCESS



UP TO 26 METRES



World Leader in Manoeuvring Tecnology



[www.yachtcontroller.it](http://www.yachtcontroller.it)